

TRENDNET[®]



Quick Installation Guide

TEW-832MDR (V1)

Table of Contents

1 English

1. Before You Start
2. Hardware Installation

1. Before You Start

Package Contents

- 1 x TEW-832MDR unit
- Quick Installation Guide
- Power adapters (12V DC, 1.5A)
- Wall mount screws

Minimum Requirements

- iPhone® with iOS 10 or newer
- Mobile device with Android™ 7 or newer
- Broadband Internet
- Installed modem
- TEW-832MDR2K

2. Hardware Installation

Option 1: MESHnet App Installation

1. Once all units are powered on, open up the APP for the existing 2 pack kit that has already been set-up prior and initiate “+” button at bottom of home screen.

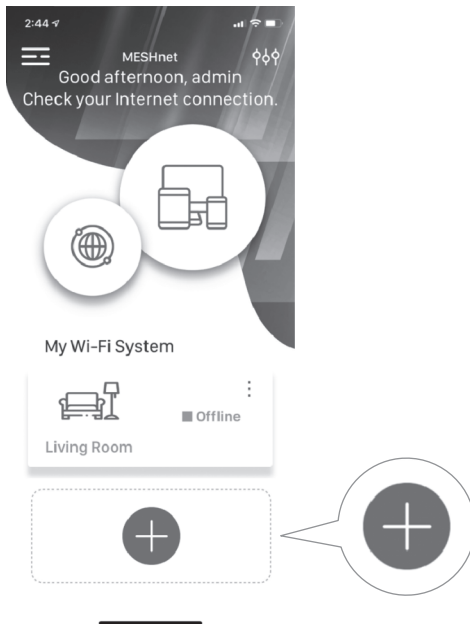

2. Click **START PAIRING**.

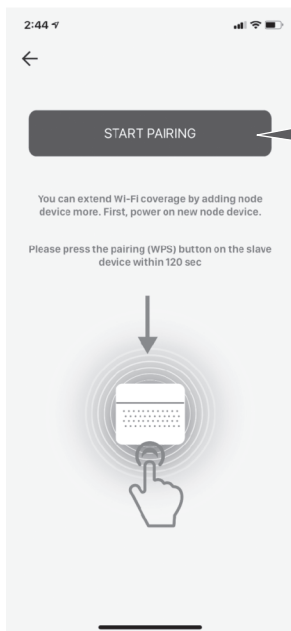

START PAIRING

ENGLISH

FRANÇAIS

DEUTSCH

ESPAÑOL

PORTUGUÊS

ITALIANO

РУССКИЙ

3. Next, go to the node labeled **Remote** and press and hold the **WPS/RESET** button for 3 seconds then release. Once initiated the **WPS/RESET** LED will begin blinking green while pairing to the Mesh network.

Note: Holding longer than 5 seconds will reset the unit back to factory defaults.

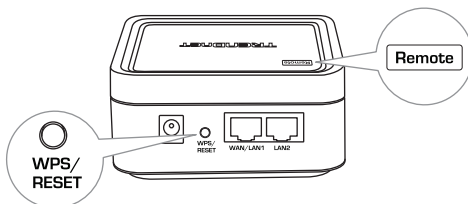

4. Once the **Remote** node is connected the **Pair** LED will turn solid green. If the **Pair** LED is blinking that means the **Remote** node should be moved closer to the other Mesh nodes.

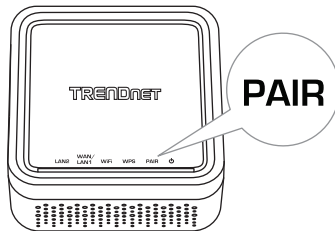
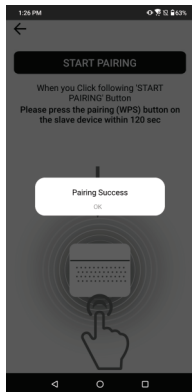

Option 2: WPS Setup

1. First, go to the node labeled **Main** and press and hold the **WPS/RESET** button for 3 seconds then release. Once initiated the **WPS/RESET** LED will begin blinking green while pairing to the Mesh network.

Note: Holding longer than 5 seconds will reset the unit back to factory defaults.

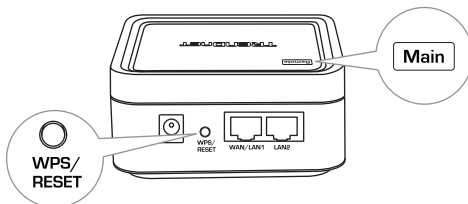

2. Next, go to the node labeled **Remote** and press and hold the **WPS/RESET** button for 3 seconds then release. Once initiated the **WPS/RESET** LED will begin blinking green while pairing to the Mesh network.

Note: Holding longer than 5 seconds will reset the unit back to factory defaults.

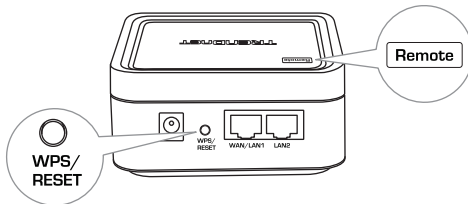

3. Once the **Remote** node is connected the **Pair** LED will turn solid green. If the **Pair** LED is blinking that means the **Remote** node should be moved closer to the other Mesh nodes.

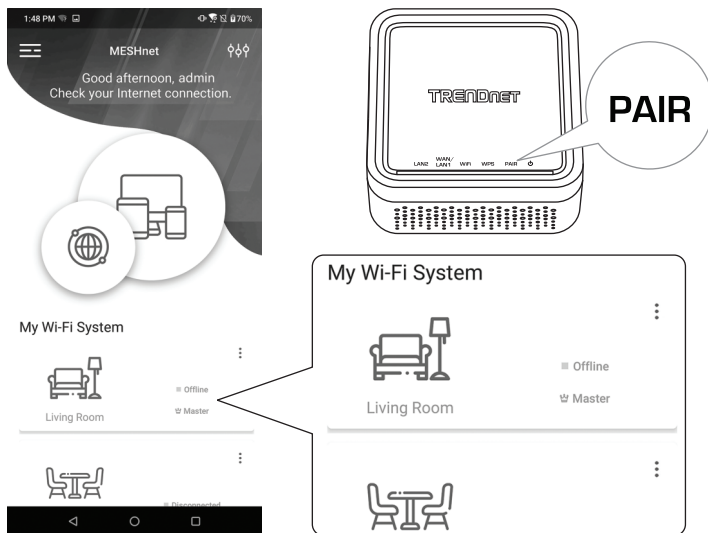

To download the latest version of the user's guide, please go to <https://www.trendnet.com/support> and select the **TEW-832MDR** within the Product Download drop-down list.

Federal Communication Commission Interference Statement

This device complies with Part 15 of the FCC Rules. Operation is subject to the following two conditions: (1) This device may not cause harmful interference, and (2) this device must accept any interference received, including interference that may cause undesired operation.

This equipment has been tested and found to comply with the limits for a Class B digital device, pursuant to Part 15 of the FCC Rules. These limits are designed to provide reasonable protection against harmful interference in a residential installation. This equipment generates, uses and can radiate radio frequency energy and, if not installed and used in accordance with the instructions, may cause harmful interference to radio communications. However, there is no guarantee that interference will not occur in a particular installation. If this equipment does cause harmful interference to radio or television reception, which can be determined by turning the equipment off and on, the user is encouraged to try to correct the interference by one of the following measures:

- Reorient or relocate the receiving antenna.
- Increase the separation between the equipment and receiver.
- Connect the equipment into an outlet on a circuit different from that to which the receiver is connected.
- Consult the dealer or an experienced radio/TV technician for help.

FCC Caution: Any changes or modifications not expressly approved by the party responsible for compliance could void the user's authority to operate this equipment.

This transmitter must not be co-located or operating in conjunction with any other antenna or transmitter.

Operations in the 5.15-5.25GHz band are restricted to indoor usage only.

Radiation Exposure Statement:

This equipment complies with FCC radiation exposure limits set forth for an uncontrolled environment. This equipment should be installed and operated with minimum distance 20cm between the radiator & your body.

Industry Canada statement:

This device complies with ISED's licence-exempt RSSs. Operation is subject to the following two conditions: (1) This device may not cause harmful interference, and (2) this device must accept any interference received, including interference that may cause undesired operation.

Le présent appareil est conforme aux CNR d'ISED applicables aux appareils radio exempts de licence. L'exploitation est autorisée aux deux conditions suivantes : (1) le dispositif ne doit pas produire de brouillage préjudiciable, et (2) ce dispositif doit accepter tout brouillage reçu, y compris un brouillage susceptible de provoquer un fonctionnement indésirable.

Caution :

(i) the device for operation in the band 5150-5250 MHz is only for indoor use to reduce the potential for harmful interference to co-channel mobile satellite systems;

(iii) where applicable, antenna type(s), antenna models(s), and worst-case tilt angle(s) necessary to remain compliant with the e.i.r.p. elevation mask requirement set forth in section 6.2.2.3 shall be clearly indicated.

Avertissement:

(i) les dispositifs fonctionnant dans la bande 5150-5250 MHz sont réservés uniquement pour une utilisation à l'intérieur afin de réduire les risques de brouillage préjudiciable aux systèmes de satellites mobiles utilisant les mêmes canaux;

(iii) lorsqu'il y a lieu, les types d'antennes (s'il y en a plusieurs), les numéros de modèle de l'antenne et les pires angles d'inclinaison nécessaires pour rester conforme à l'exigence de la p.i.r.e. applicable au masque d'élévation, énoncée à la section 6.2.2.3, doivent être clairement indiqués. Radiation Exposure Statement:

This equipment complies with ISED radiation exposure limits set forth for an uncontrolled environment. This equipment should be installed and operated with greater than 20cm between the radiator & your body.

Déclaration d'exposition aux radiations:

Cet équipement est conforme aux limites d'exposition aux rayonnements ISED établies pour un environnement non contrôlé. Cet équipement doit être installé et utilisé à plus de 20 cm entre le radiateur et votre corps.

Declaration of Conformity

TRENDnet®

Manufacturer's Name and Address

TRENDnet, Inc.
20675 Manhattan Place
Torrance, CA 90501 USA

Zwolsestraat 156 2587 WB
The Hague The Netherlands



Product Information:

Model Number: TEW-832MDR
Product Name: AC1200 Dual Band WiFi EasyMesh™
Trade Name: TRENDnet

TRENDnet hereby declare that the product is in compliance with the essential requirements and other relevant provisions under our sole responsibility.

Safety	EN 62368-1:2014+A11:2017
EMC	EN 55032:2015+AC:2016 (CISPR32:2015/COR1:2016) (Class A)
	EN 61000-3-2:2014
	EN 61000-3-3:2013
	EN 55024:2010+A1:2015
	IEC 61000-4-2:2008
	IEC 61000-4-3:2006+A1:2007+A2:2010
	IEC 61000-4-4:2012
	IEC 61000-4-5:2014/AMD1:2017
	IEC 61000-4-6:2013
	IEC 61000-4-8:2009
	IEC 61000-4-11:2004/AMD1:2017

This product is herewith confirmed to comply with the Directives

Directives	EMC Directive 2014/30/EU
	RoHS Directive 2011/65/EU
	WEEE Directive 2012/19/EU
	REACH Regulation (EC) No. 1907/2006
	Low Voltage Directive 2014/35/EU
	Ecodesign Directive 2009/125/EC

Person responsible for this declaration.

Place of Issue: Torrance, California, USA

Date: October 21, 2020

Name: Sonny Su

Title: Director of Technology

Signature:

A handwritten signature in black ink, appearing to read 'Sonny Su', is written over a horizontal line.





Wall-mounted instructions

The Unit has two wall-mount slots on its bottom panel.

Before you begin, make sure you have two screws that indicate a diameter measurement of 0.1377 inches (4.0mm).

- (1) Determine where you want to mount the unit.
- (2) Drill two holes into the wall. Make sure adjacent holes are 4.51 inches (114 mm) apart.
- (3) Maneuver the unit so the wall-mount slots line up with the two screws.
- (4) Place the wall-mount slots over the screws and slide the unit down until the screws fit snugly into the wall-mount slots.
- (5) Screw type T3 x 15mm x 2

The equipment power supply cord shall be connected to a socket-outlet with earthing connection.

Certifications

This device complies with Part 15 of the FCC Rules.

Operation is subject to the following two conditions:

- (1) This device may not cause harmful interference.
- (2) This device must accept any interference received.

Including interference that may cause undesired operation.



	AT	BE	BG	HR	CY	CZ	DK
	EE	FI	FR	DE	EL	HU	IE
	IT	LV	LT	LU	MT	NL	PL
	PT	RO	SK	SI	ES	SE	UK

This device is restricted to indoor use

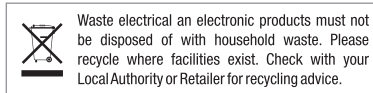

Technical Support

If you have any questions regarding the product installation, please contact our Technical Support.

Toll free US/Canada: **1-866-845-3673**

Regional phone numbers available

at www.trendnet.com/support

TRENDnet

20675 Manhattan Place

Torrance, CA 90501

USA

Applies to PoE Products Only: This product is to be connected only to PoE networks without routing to the outside plant.

Note

The Manufacturer is not responsible for any radio or TV interference caused by unauthorized modifications to this equipment. Such modifications could void the user's authority to operate the equipment.

Advertencia

En todos nuestros equipos se mencionan claramente las características del adaptador de alimentación necesario para su funcionamiento. El uso de un adaptador distinto al mencionado puede producir daños físicos y/o daños al equipo conectado. El adaptador de alimentación debe operar con voltaje y frecuencia de la energía eléctrica domiciliar existente en el país o zona de instalación.

Product Warranty Registration

Please take a moment to register your

product online. Go to TRENDnet's website at:

www.trendnet.com/register